

WPC Wall Cladding Installation Instruction



Tools and Accessories



Chainsaw



Tape measure



Drill



Level



Gas nailer



Joist



SS screw



Starting clip



Dovetail nails



L-corner

Easy Installation

Fixed joist

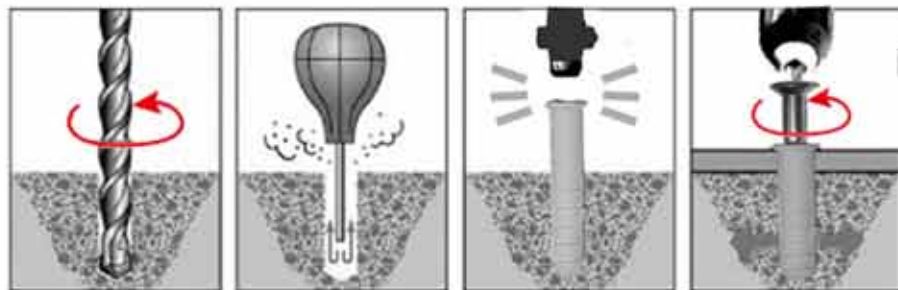

Expansion screws



about 30 cm

• Fixed the joist with expansion screws.

• Every 0.5 meters an expansion screw.

WPC Wall Cladding Installation Instruction

Fixd Starting clip

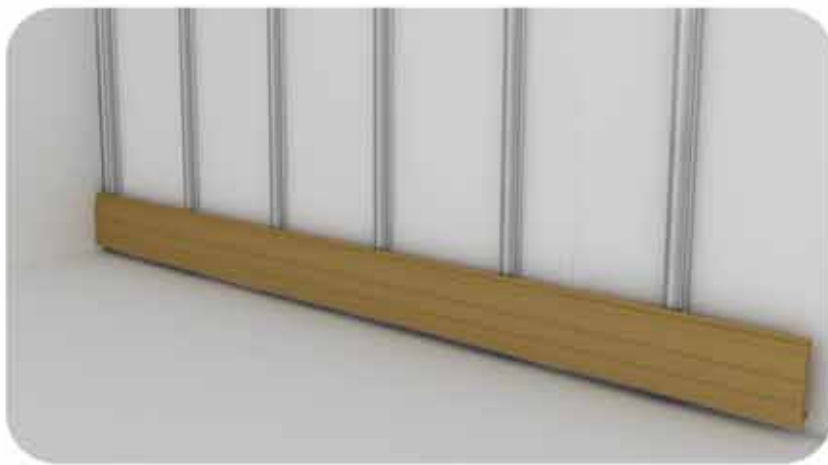
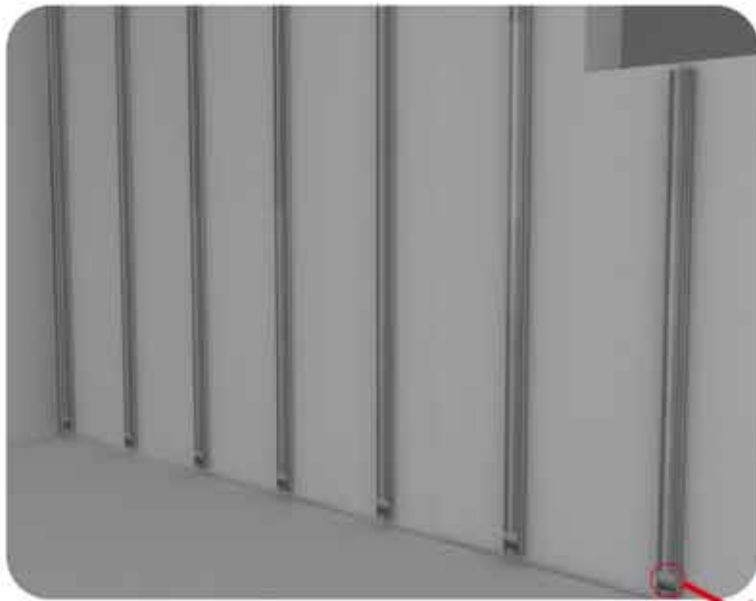

Fixd wall cladding

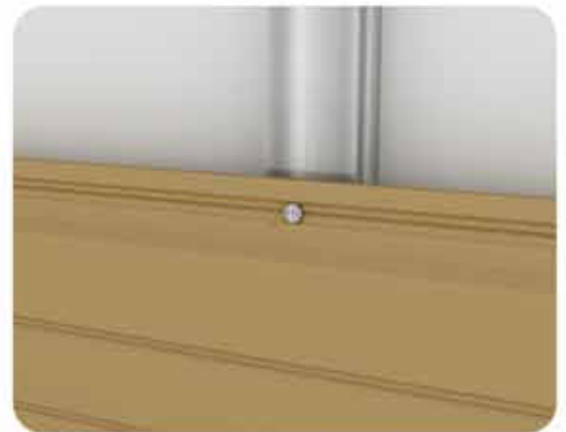

Fixed the first panel at the bottom.

WPC Wall Cladding Installation Instruction

Fixd wall cladding

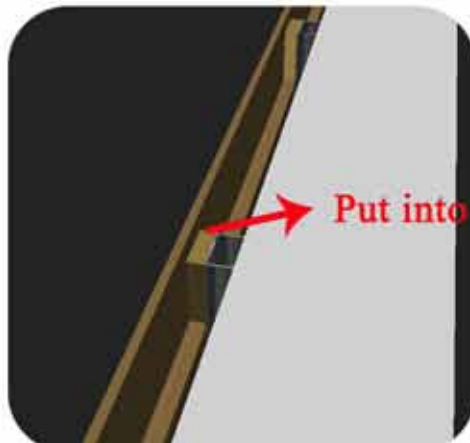
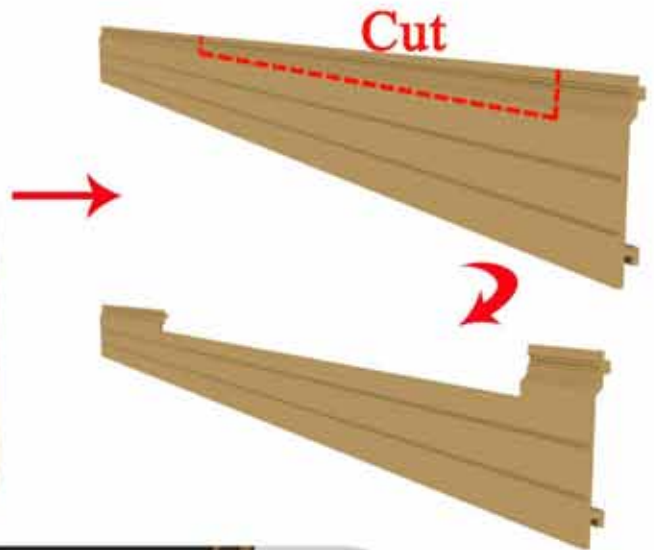
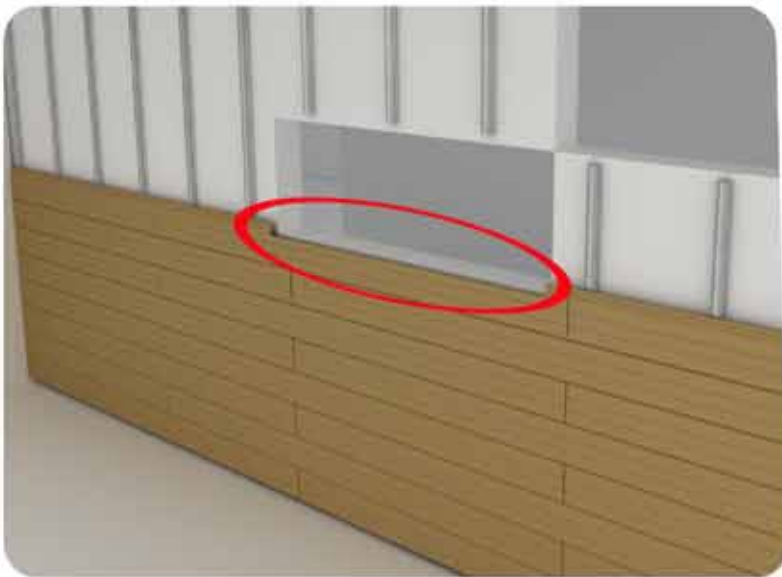
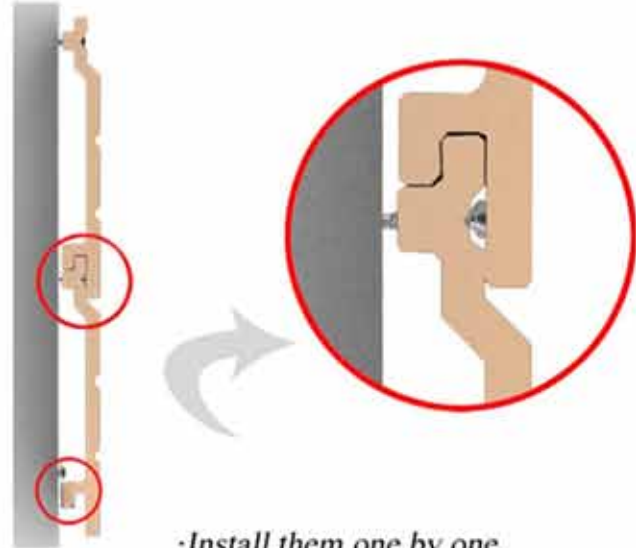
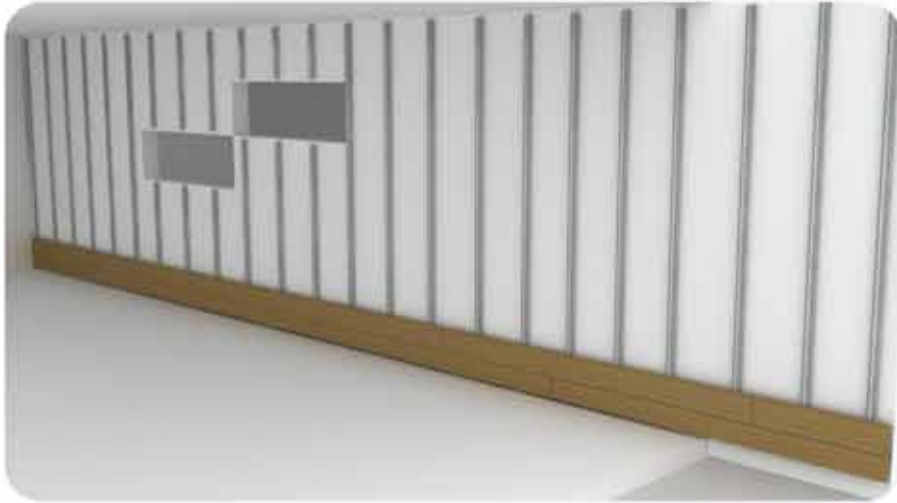

WPC Wall Cladding Installation Instruction

Fixd wall cladding

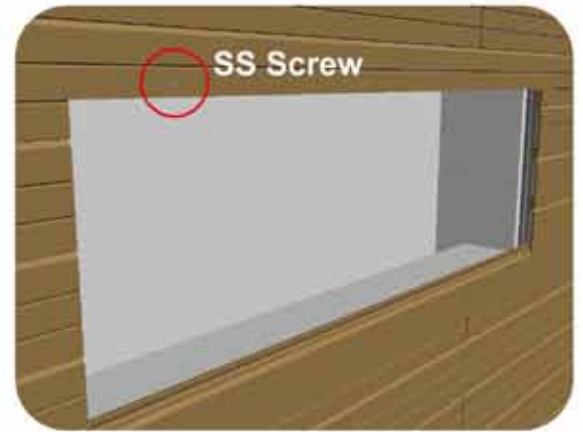

Install L Corner

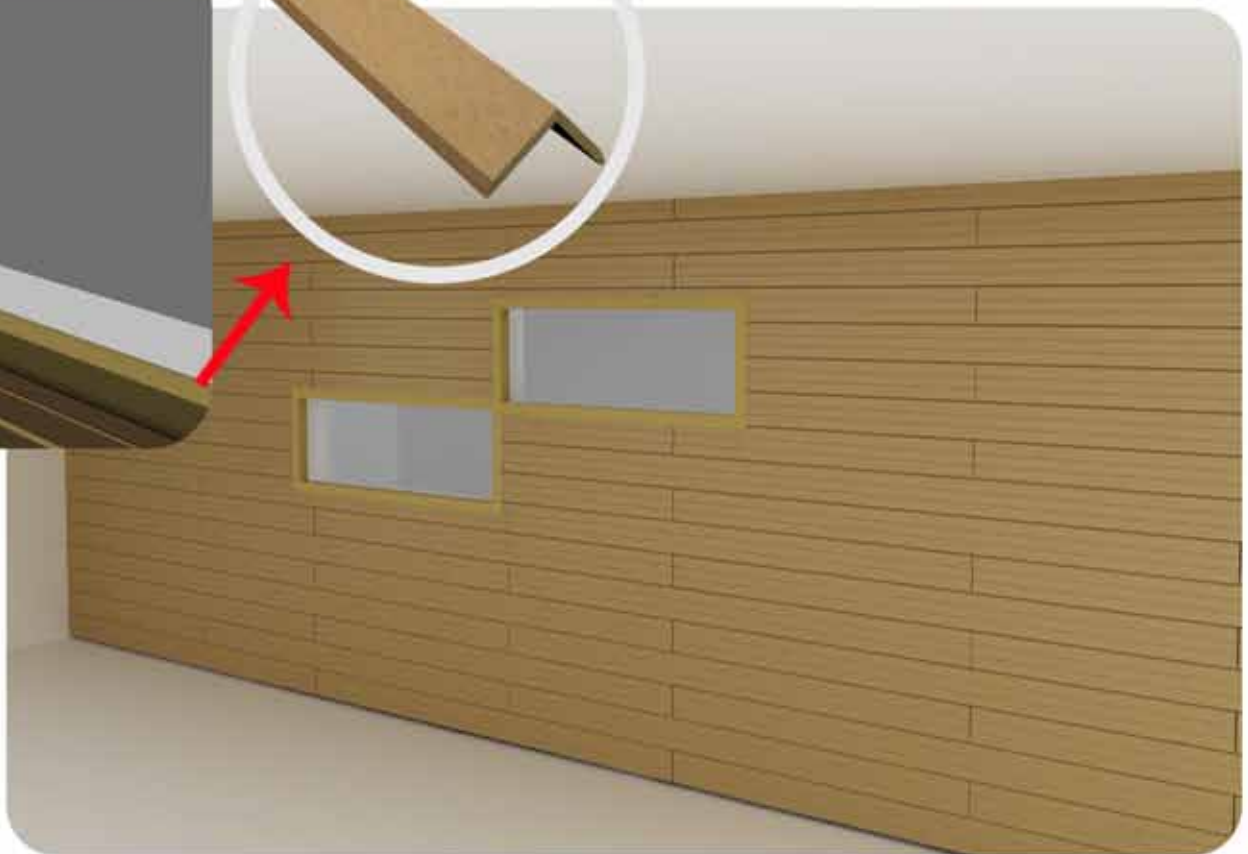
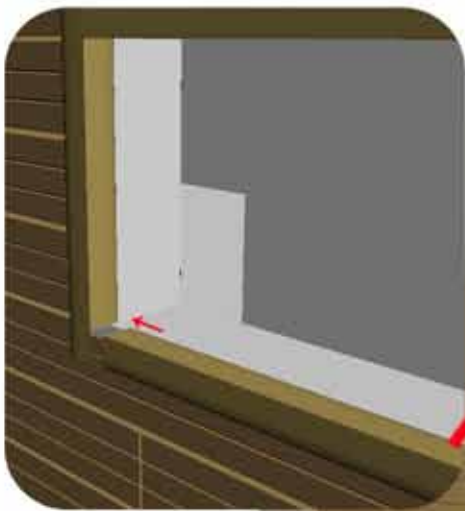

WPC Wall Cladding Installation Instruction

Install L Corner

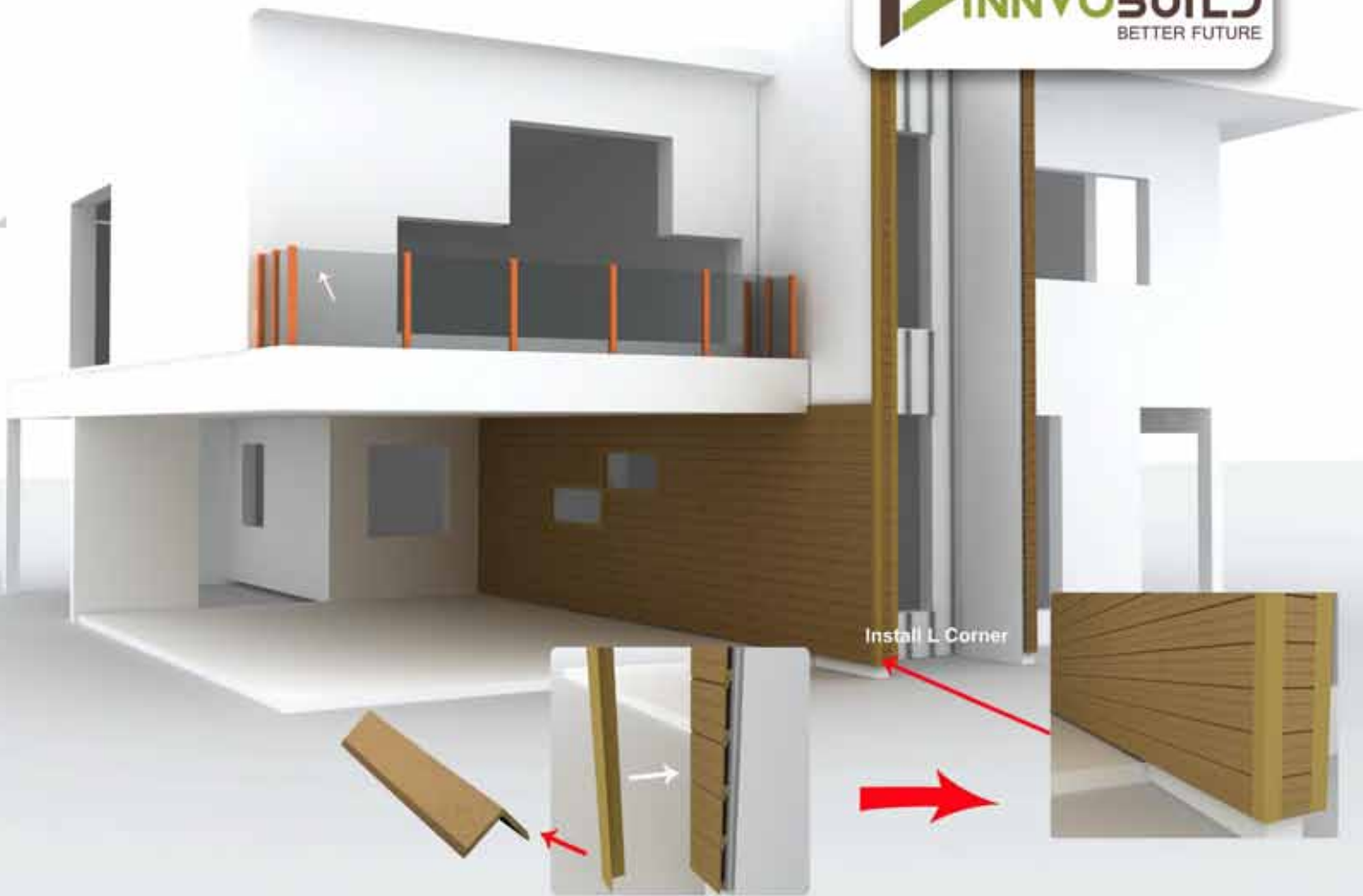

One side wall's installation be the example, and other walls is same with it.